

# OWNER'S MANUAL



SERIAL NUMBER HERE

DATE OF PURCHASE



# INSTRUCTIONS

CONGRATULATIONS ON THE PURCHASE OF YOUR NEW BATCA LINK SMITH MACHINE. THIS GYM WILL PROVIDE YOU WITH A LIFETIME OF ENJOYMENT TO MEET YOUR STRENGTH TRAINING NEEDS. BATCA FITNESS SYSTEMS STRIVES TO BUILD THE BEST QUALITY GYMS AND TO PACKAGE THESE GYMS IN SUCH A WAY TO AVOID ANY DAMAGE DURING SHIPPING.

IN ORDER TO GET STARTED WITH YOUR ASSEMBLY YOU SHOULD FIRST FAMILIARIZE YOURSELF WITH THIS MANUAL. IT IS RECOMMENDED THAT YOU READ THROUGH EACH STEP THOROUGHLY BEFORE YOU BEGIN. BEGIN BY OPENING YOUR BOXES AND SEPARATING ALL OF YOUR PARTS. VERIFY THAT ALL PARTS ARE ACCOUNTED FOR AND HAVE NO DAMAGE. WHEN ALL PARTS ARE ACCOUNTED FOR, YOU MAY BEGIN YOUR ASSEMBLY. SOME ITEMS MAY HAVE BEEN PRE-ASSEMBLED FOR YOUR CONVENIENCE. PLEASE NOTE THAT HARDWARE QUANTITIES SHOWN REFLECT TOTAL QUANTITIES FOR YOUR GYM AND MAY NOT REFLECT ACTUAL QUANTITIES IN EACH BAG. ASSEMBLE YOUR GYM ON A SOLID LEVEL SURFACE. THIS WILL ENSURE THE BEST POSSIBLE PERFORMANCE, FUNCTION, AND SAFETY FOR THE GYM AND YOUR WORKOUT.

ASSEMBLE YOUR GYM ACCORDING TO THE STEP BY STEP INSTRUCTIONS FOUND IN THIS MANUAL. FAILURE TO DO SO WILL VOID YOUR WARRANTY AND MAY RESULT IN PERSONAL INJURY. AFTER ASSEMBLY, YOU SHOULD CHECK EACH STATION TO ENSURE CORRECT OPERATION. IF A PROBLEM ARISES, RECHECK YOUR ASSEMBLY WITH THESE INSTRUCTIONS TO VERIFY CORRECT ASSEMBLY. IF YOU ARE UNABLE TO CORRECT A PROBLEM OR HAVE QUESTIONS WITH YOUR ASSEMBLY PLEASE CONTACT YOUR AUTHORIZED BATCA DEALER.

## WARNING

BATCA FITNESS SYSTEMS HAS BUILT THIS GYM TO GIVE YOU A SAFE, EFFECTIVE AND ENJOYABLE WORKOUT. HOWEVER, THERE IS A RISK ASSUMED BY INDIVIDUALS WHO USE THIS TYPE OF EQUIPMENT. IT IS VERY IMPORTANT THAT ALL WARNINGS AND INSTRUCTIONS ARE READ AND FOLLOWED BEFORE BEGINNING ANY EXERCISE PROGRAM.

IT IS ALSO VERY IMPORTANT TO READ AND FOLLOW THE PREVENTATIVE MAINTENANCE SCHEDULE DESCRIBED IN THIS MANUAL. IF ANY OF THE WARNING LABELS OR STICKERS ARE WORN, FADED, TORN, SCRATCHED OR MISSING THEY SHOULD BE REPLACED IMMEDIATELY.

**WARNING: THERE IS A RISK ASSUMED BY INDIVIDUALS WHO USE THIS TYPE OF EQUIPMENT. TO MINIMIZE RISK ALWAYS FOLLOW THESE RULES.**

- 1) IT IS ESSENTIAL THAT YOU CONSULT WITH YOUR PHYSICIAN BEFORE BEGINNING ANY EXERCISE PROGRAM.
- 2) INSPECT EQUIPMENT BEFORE EACH USE FOR LOOSE, WORN, OR FRAYED PARTS (INCLUDING CABLES, NUTS AND BOLTS). REPLACE PARTS AT FIRST SIGNS OF WEAR (USE ONLY GENUINE BATCA REPLACEMENT PARTS). USE OF EQUIPMENT THAT IS DAMAGED, WORN, FRAYED OR NOT COMPLETELY ASSEMBLED ON A SOLID, LEVEL SURFACE MAY RESULT IN INJURY.
- 3) MAKE SURE ALL ADJUSTMENT PINS ARE FULLY ENGAGED BEFORE USING EQUIPMENT.
- 4) KEEP ALL PARTS OF THE BODY AND CLOTHING OUTSIDE THE PATH OF ANY MOVING PARTS OF THE GYM. BE ALERT TO THE POSSIBILITY OF INJURY. DO NOT BE CARELESS.
- 5) MINORS AND CHILDREN SHOULD NOT BE ALLOWED TO PLAY ON OR AROUND THIS GYM.

## TABLE OF CONTENTS

	<u>PAGE</u>		<u>PAGE</u>
INSTRUCTIONS	2	MAINTENANCE	15
PARTS LISTING	3	WARRANTY	16
HARDWARE COMPARISON	4-7	FLOOR PLAN LAYOUT	17
MAIN ASSEMBLY	8-14		

# FRAME COMPONENTS

ITEM NO.	PART NUMBER	DESCRIPTION	QTY.
1	BFP-11012	BACK UPRIGHT SUPPORT (USER LEFT)	1
2	BFP-10997	BACK UPRIGHT SUPPORT (USER RIGHT)	1
3	BFP-52326	FRAME CONNECTION PLATE	2
4	BFP-11005	REAR BOTTOM CROSSMEMBER	1
5	BFP-10993	SMITH MACHINE BASE	2
6	BFP-10995	FRONT UPRIGHT SUPPORT (USER RIGHT)	1
7	BFP-10994	FRONT UPRIGHT SUPPORT (USER LEFT)	1
8	BFP-10996	CHIN UP CROSS BAR	1
9	BFP-52299	FRAME CONNECTION PLATE	2
10	BFP-10998	DIP STATION CROSSMEMBER	1
11	BFP-11009	10" WEIGHT TREE (USER RIGHT)	1
12	BFP-11008	10" WEIGHT TREE (USER LEFT)	1
13	BFP-11010	11" WEIGHT TREE (USER RIGHT)	1
14	BFP-11007	11" WEIGHT TREE (USER LEFT)	1
15	BFP-11006	12" WEIGHT TREE (USER LEFT)	1
16	BFP-11011	12" WEIGHT TREE (USER RIGHT)	1
17	BFP-52305	ANTI-DEFLECTION PLATE	4
18	BFP-52307	RACKING PLATES	4
19	BFP-11021	FREWEIGHT SAFETY CATCHES	2
20	BFP-11001	SMITH BAR GUIDE SLEEVE (USER LEFT)	1
21	BFP-11003	SMITH BAR GUIDE SLEEVE (USER RIGHT)	1
22	BFL-50268	SMITH SAFETY STOP PLATES	4
23	BFM-50651	SMITH SAFETY STOP SPACER	2
24	BFM-51181	SMITH SAFETY STOP HANDLE	2
25	BFP-10999	SMITH SAFETY STOP GUIDE SLEEVE (USER LEFT)	2
26	BFP-52295	GUIDE ROD CLAMP	4
27	BFP-52306	GUIDE ROD	2
28	BFM-10697	SMITH OLYMPIC BAR	1
29	BFP-11002	OLYMPIC BAR COLLAR (USER LEFT)	1
30	BFP-11004	OLYMPIC BAR COLLAR (USER RIGHT)	1
31	BFP-52391	1" STEEL BAR INSERT	2

# HARDWARE

ITEM NO.	PART NUMBER	DESCRIPTION	QTY .
32	BFP-52393	SHCS 1/4" x 3/4"	8
33	BFP-52340	SHCS 3/8" x 3/4"	2
34	BFP-51653	SHCS 3/8" x 1 1/4"	4
35	BFP-52390	FHSCS 3/8" x 1 1/4"	6
36	BFP-51759	SHCS 3/8" x 2"	2
37	BFP-52337	SHCS 1/2" x 3"	12
38	BFP-52236	SHCS 1/2" x 3 1/4"	24
39	BFH-50146	3/8" FLAT WASHER	22
40	BFH-50251	1/2" FLAT WASHER	72
41	BFH-50157	3/8" NYLOCK	12
42	BFH-50155	1/2" NYLOCK	36
43	BFP-52392	3/8" SHOULDER BOLT	2

# TOOLS REQUIRED

- 3/4" RATCHET
- 9/16" RATCHET
- ALLEN WRENCH SET
- TAPE MEASURE

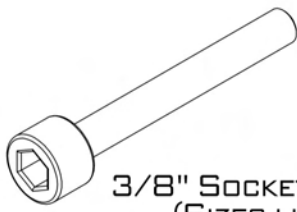

**3/8" SOCKET HEAD CAP SCREW**  
(SIZES LISTED IN CHART)

PART #	BOLT SIZE
BFP-52340	3/8" x 3/4"
BFP-52376	3/8" X 1"
BFP-51653	3/8" x 1 1/4"
BFP-51697	3/8" x 1 1/2"
BFP-51759	3/8" x 2"
BFP-51752	3/8" x 2 1/4"
BFP-51750	3/8" x 2 3/4"
BFP-51747	3/8" x 3"
BFP-51748	3/8" x 3 1/4"
BFP-51760	3/8" x 3 1/2"
BFP-52345	3/8" x 4"
BFP-51884	3/8" X 4 1/4"
BFP-51751	3/8" x 4 1/2"
BFP-51753	3/8" x 4 3/4"
BFP-51799	3/8" x 5"
BFP-51756	3/8" x 5 1/4"
BFP-52364	3/8" x 6"

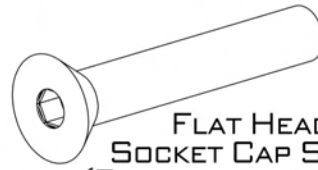

**FLAT HEAD SOCKET CAP SCREW**  
(SIZES LISTED IN CHART)

PART #	BOLT SIZE
BFH-50144	FHSCS 3/8"-16 x 1"
BFP-52377	FHSCS 3/8" x 2"
BFH-50145	FHSCS 3/8"-16 x 2 1/4"
BFP-52374	FHSCS 3/8" x 2 3/4"

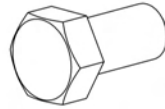

**HEX HEAD CAP SCREW**  
(HCS) 3/8" x 3/4"  
(BFH-50254)

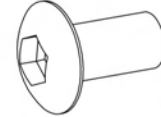

**BUTTON HEAD SOCKET CAP SCREW**  
(BHSCS) 3/8" x 3/4"  
BFP-52430

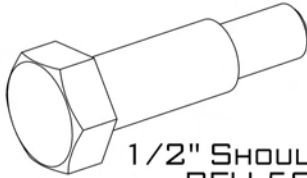

**1/2" SHOULDER BOLT**  
BFH-50249

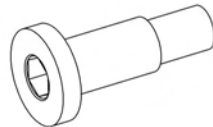

**1 1/4" SHOULDER BOLT**  
BFH-50250

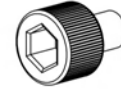

**ZINC PLATED SHCS**  
5/16" x 1/2"  
(BFP-52372)

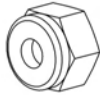

**5/16"-18 NYLOCK**  
BFH-50267



**3/8"-16 THIN NYLOCK**  
BFH-50247

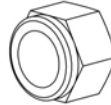

**3/8"-16 NYLOCK**  
BFH-50157

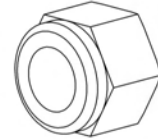

**1/2"-13 NYLOCK**  
BFH-50251



**1/2" JAM NUT**  
BFH-50256



**3/8" JAM NUT**  
BFH-50149

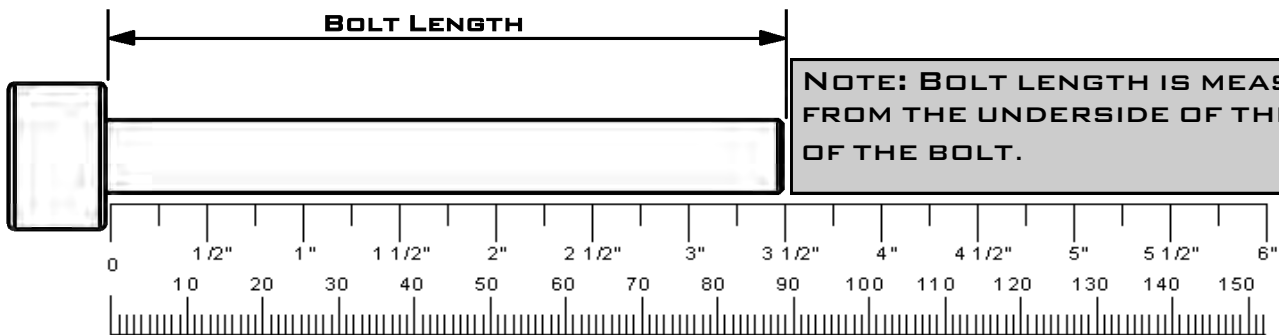

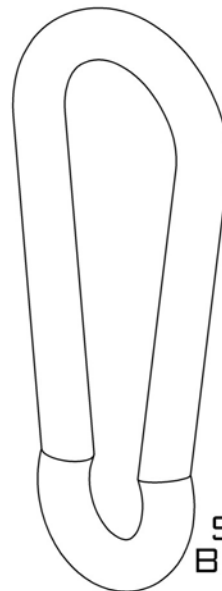
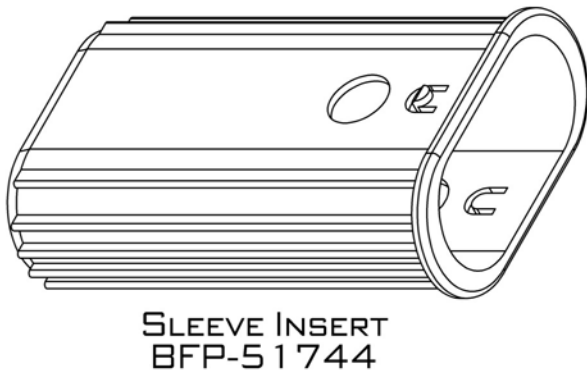
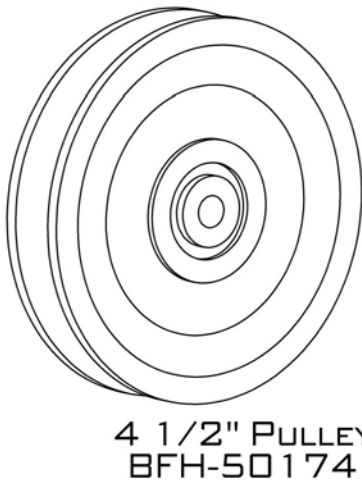
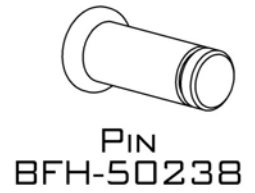
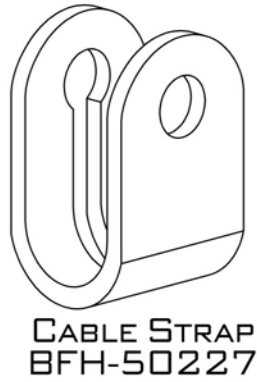
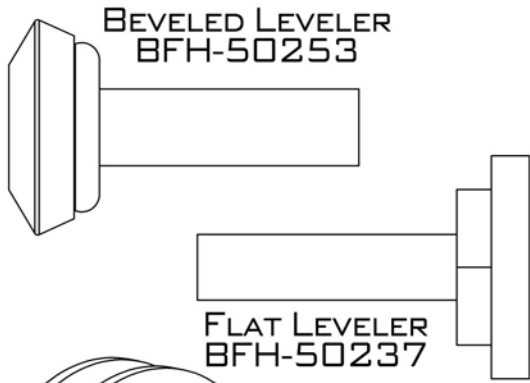

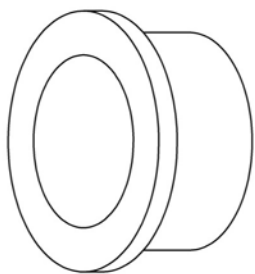

1" BRONZE BUSHING  
BFH-50101

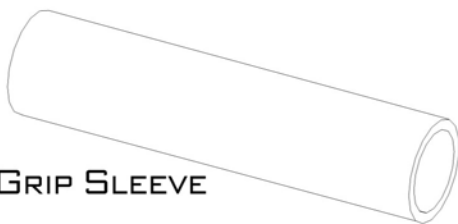

GRIP SLEEVE

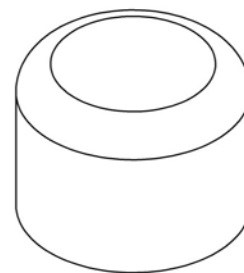

1" OUTER PLASTIC CAP  
BFH-50111



GRIP CAP



GRIP COLLAR

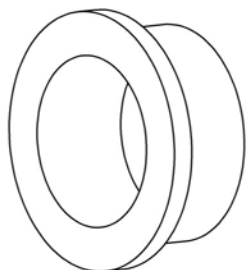

1" BRONZE BUSHING x 1/2 L  
BFH-50297

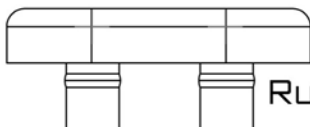

BFH-50222

RUBBER BUMPERS

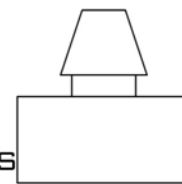

BFH-50200



5/8" BRONZE BUSHING  
BFH-50102

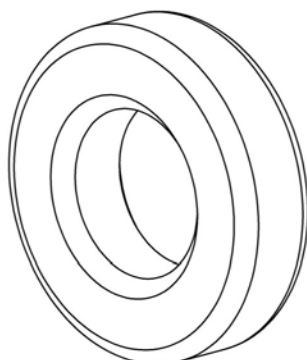

RADIAL BEARING  
BFH-50602

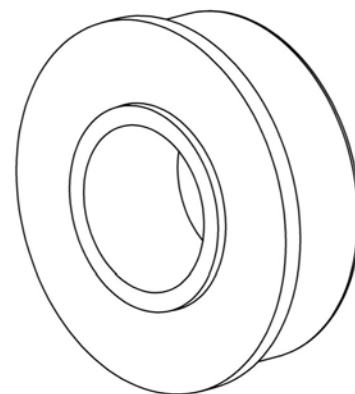

FLANGED RADIAL BEARING  
BFP-51949

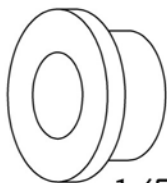

1/2" BRONZE BUSHING  
BFH-50103



CABLE PIVOT BUSHING  
BFH-50248

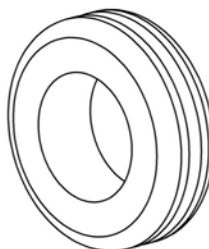

RUBBER GROMMET  
BFH-50199

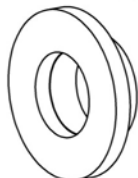

SHORT 1/2" BUSHING  
BFH-50244



1/2" SNAP RING  
BFH-50166

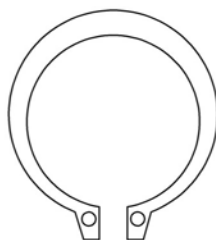

1" SNAP RING  
BFH-50165

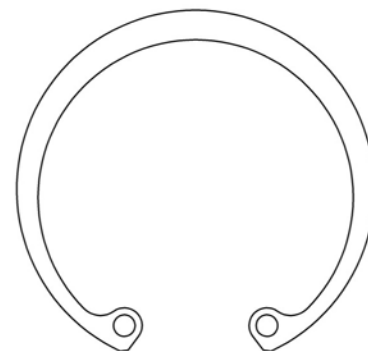

2 1/2" SNAP RING  
BFH-50604

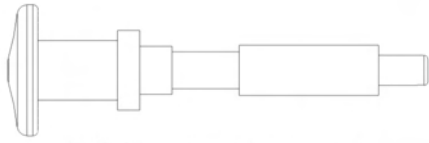

3/8" LONG PULL PIN  
BFM-51176

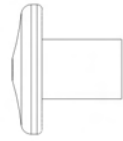

PULL PIN HANDLE  
BFM-51181



PLASTIC END CAP  
(BFP-52101)



1/2" LONG PULL PIN  
BFM-51172

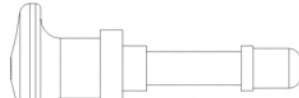

3/8" SHORT PULL PIN  
BFM-51175

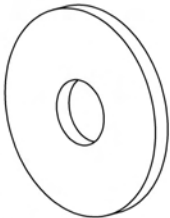

3/8" FENDER WASHER  
BFH-50242



3/8" FLAT WASHER  
BFH-50146



3/8" CURVED WASHER  
BFH-50204

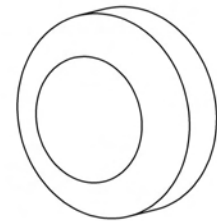

SCREW CAP COVER  
BFH-50112



SCREW CAP WASHER  
BFH-50113



3/8" LOCK WASHER  
BFH-50147



MAGNETIC WEIGHT STACK PIN  
BFM-51173



BAR CATCH RUBBER  
SLEEVE  
BFH-50240



SIDE MOUNTED  
FLANGE BEARING  
BFH-50171

**ITEMS NOT SHOWN.**

PART #	DESCRIPTION
BFH-50259	MIDNIGHT BLACK PAINT
BFH-50278	SILVER METALLIC PAINT
BFH-50198	LARGE LOGO
BFH-50236	FOAM GRIP
BFH-50262	SILICON GEL PACK
BFC-10101	1 INCH CHAIN
BFC-10102	12 INCH CHAIN

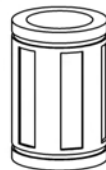

LINEAR BEARING  
BFH-50627



BEARING RETAINING  
CLIP  
BFH-50628



**PLEASE FOLLOW ALL DIRECTIONS VERY CAREFULLY FOR PROPER INSTALLATION.**

**STEP 1:**



**NOTE: FOR A MORE CONSISTENT APPEARANCE, POSITION ALL BOLTS IN THE DIRECTION SHOWN IN EACH FIGURE.**

ALL FLAT WASHERS AND NYLOCKS ARE 1/2" UNLESS OTHERWISE NOTED.



**DO NOT TIGHTEN BOLTS UNTIL STEP 3**

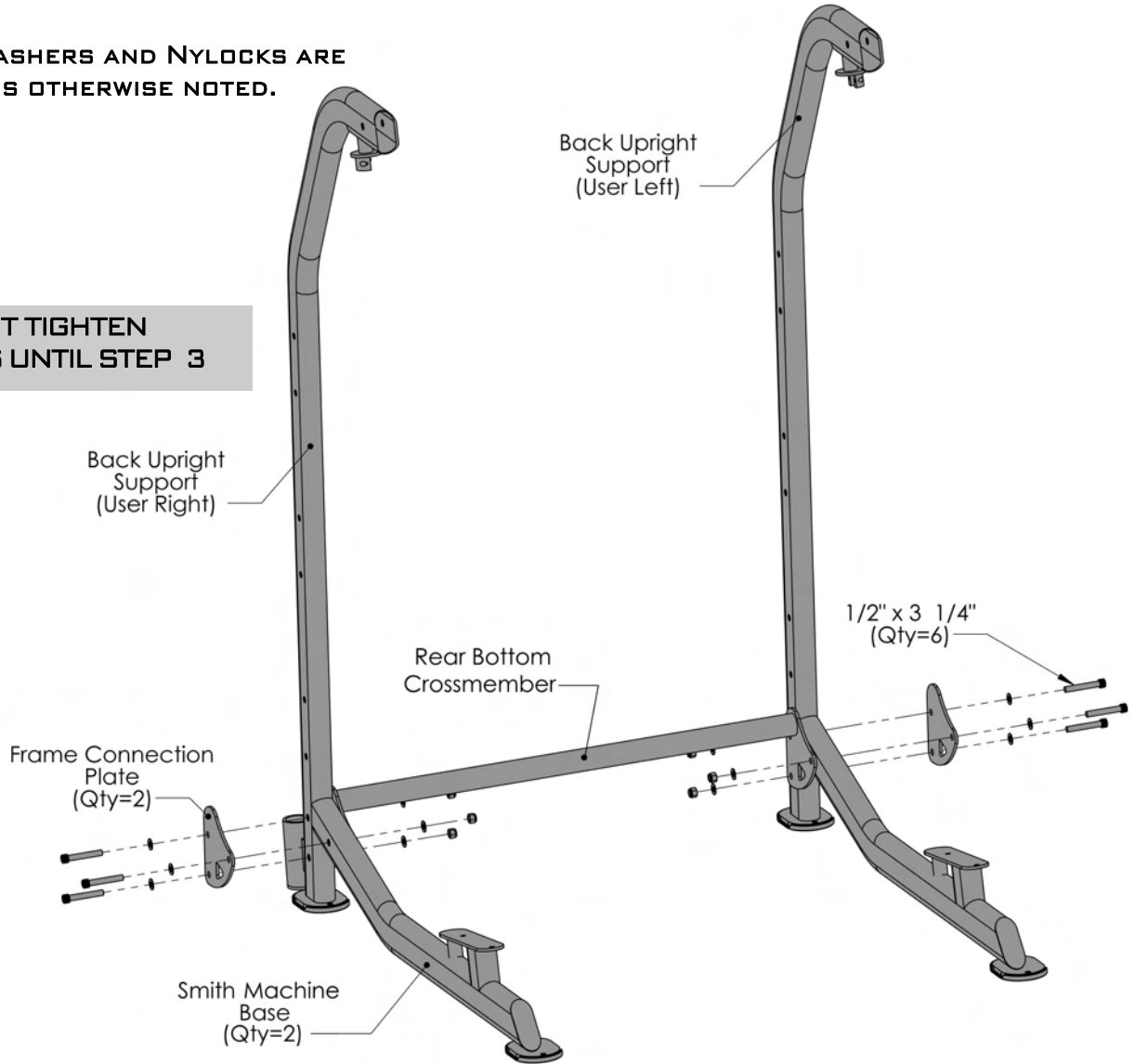

ITEM #	PART #	DESCRIPTION	QTY
1	BFP-11012	BACK UPRIGHT SUPPORT (USER LEFT)	1
2	BFP-10997	BACK UPRIGHT SUPPORT (USER RIGHT)	1
3	BFP-52326	FRAME CONNECTION PLATE	2
4	BFP-11005	REAR BOTTOM CROSSMEMBER	1
5	BFP-10993	SMITH MACHINE BASE	2
38	BFP-52236	SHCS 1/2" x 3 1/4"	6
40	BFH-50251	1/2" FLAT WASHER	12
42	BFH-50155	1/2" NYLOCK	6



## STEP 2:

**DO NOT TIGHTEN BOLTS UNTIL STEP 3**

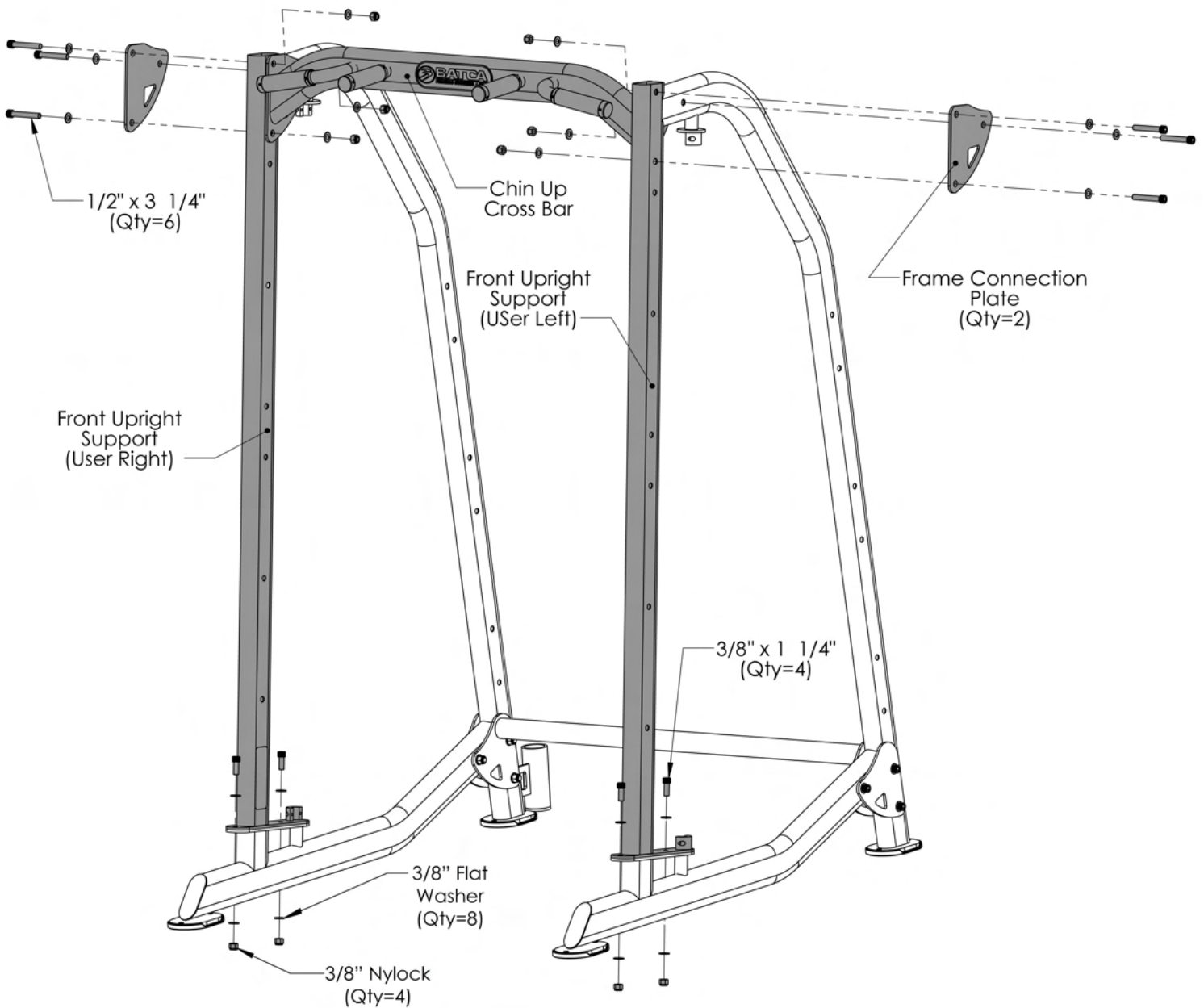

ITEM #	PART #	DESCRIPTION	QTY
6	BFP-10995	FRONT UPRIGHT SUPPORT (USER RIGHT)	1
7	BFP-10994	FRONT UPRIGHT SUPPORT (USER LEFT)	1
8	BFP-10996	CHIN UP CROSS BAR	1
9	BFP-52299	FRAME CONNECTION PLATE	2
34	BFP-51653	SHCS 3/8" x 1 1/4"	4
38	BFP-52236	SHCS 1/2" x 3 1/4"	6
39	BFH-50146	3/8" FLAT WASHER	8
40	BFH-50251	1/2" FLAT WASHER	12
41	BFH-50157	3/8" NYLOCK	4
42	BFH-50155	1/2" NYLOCK	6

ALL FLAT WASHERS AND NYLOCKS ARE 1/2" UNLESS OTHERWISE NOTED.

### STEP 3:

**!** MAKE SURE ALL BOLTS ARE TIGHTENED BEFORE MOVING ON

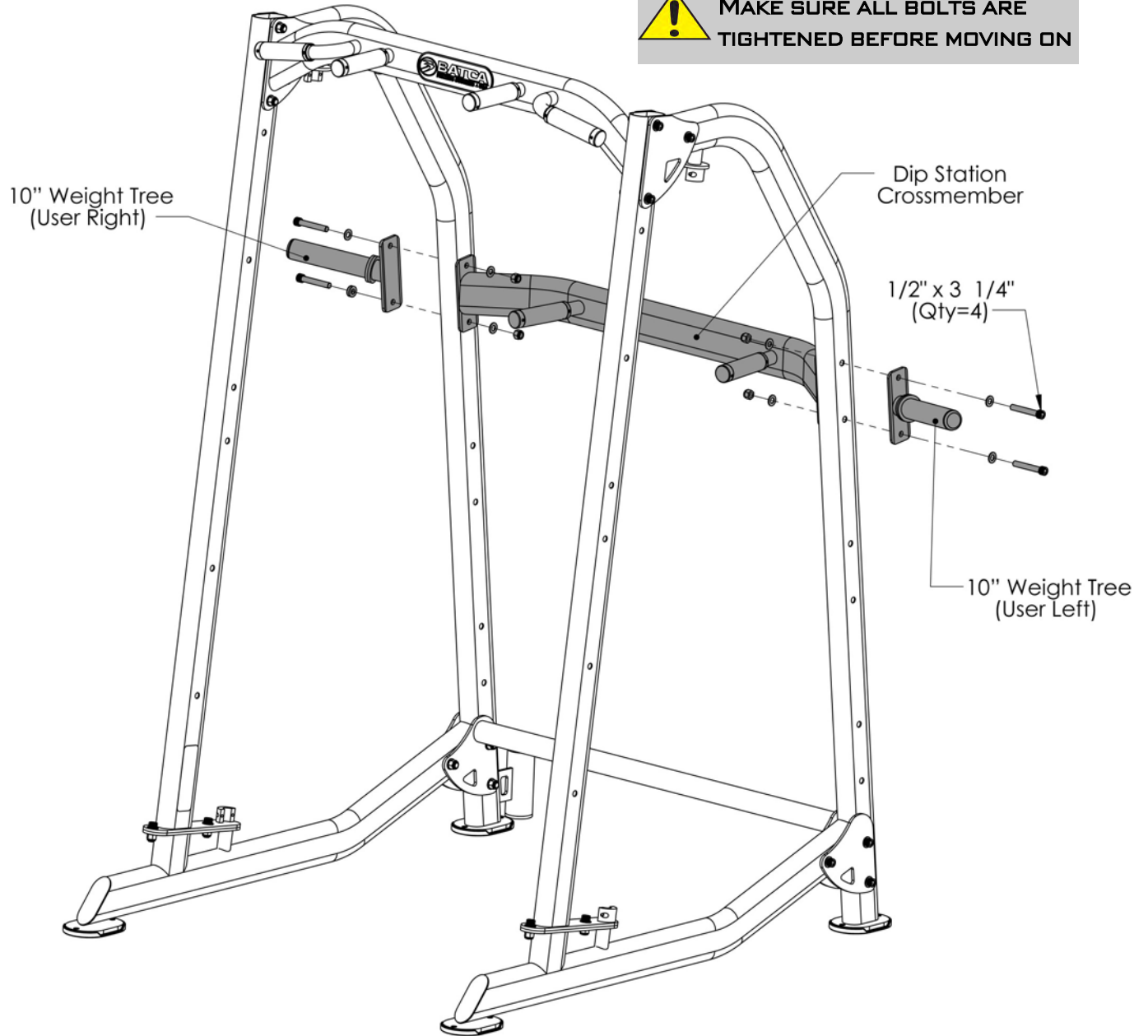

ALL FLAT WASHERS AND NYLOCKS ARE 1/2" UNLESS OTHERWISE NOTED.

ITEM #	PART #	DESCRIPTION	QTY
10	BFP-10998	DIP STATION CROSSMEMBER	1
11	BFP-11009	10" WEIGHT TREE (USER RIGHT)	1
12	BFP-11008	10" WEIGHT TREE (USER LEFT)	1
38	BFP-52236	SHCS 1/2" x 3 1/4"	4
40	BFH-50251	1/2" FLAT WASHER	8
42	BFH-50155	1/2" NYLOCK	4

**STEP 4:**

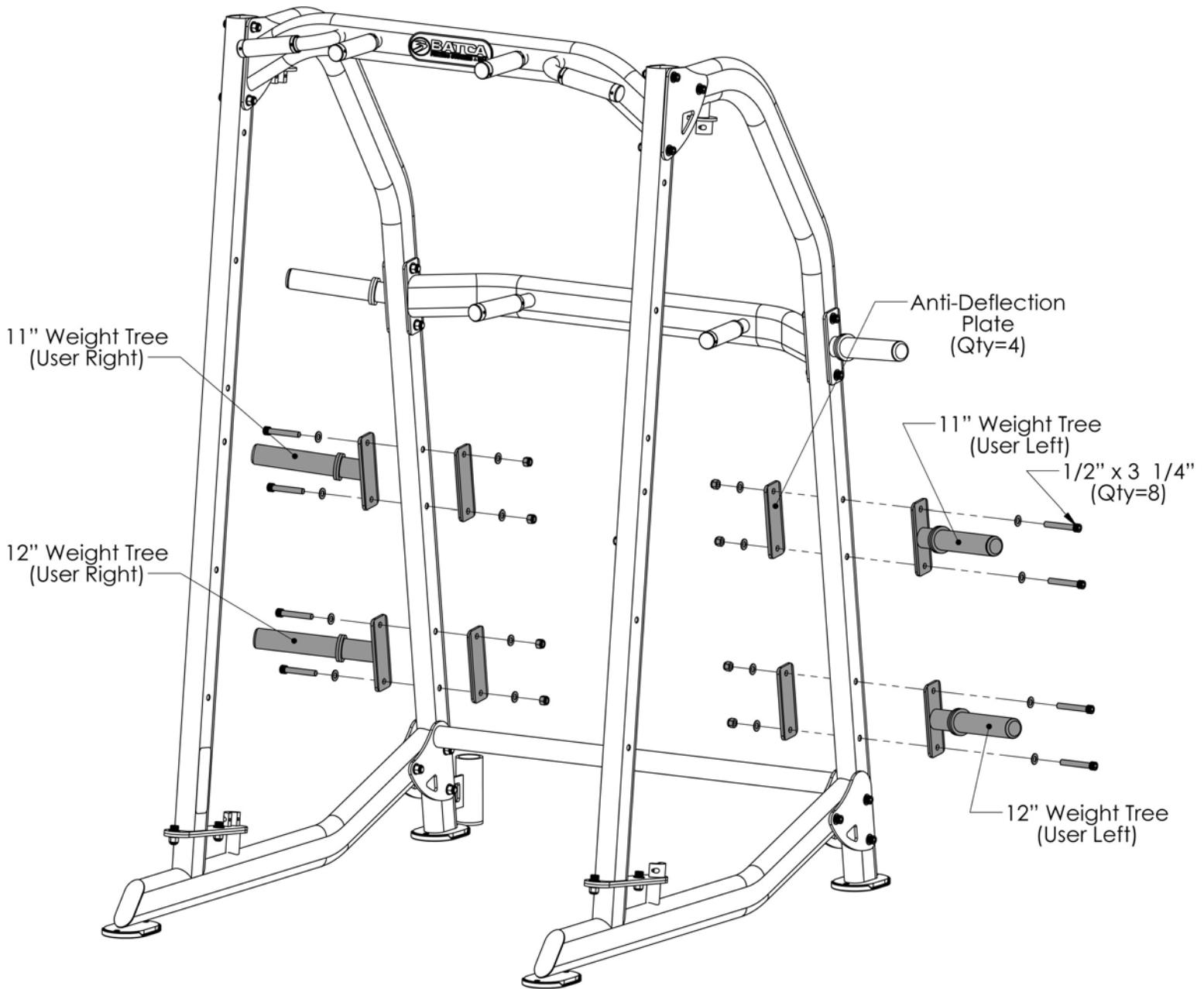

ITEM #	PART #	DESCRIPTION	QTY
13	BFP-11010	11" WEIGHT TREE (USER RIGHT)	1
14	BFP-11007	11" WEIGHT TREE (USER LEFT)	1
15	BFP-11006	12" WEIGHT TREE (USER LEFT)	1
16	BFP-11011	12" WEIGHT TREE (USER RIGHT)	1
17	BFP-52305	ANTI-DEFLECTION PLATE	4
38	BFP-52236	SHCS 1/2" x 3 1/4"	8
40	BFH-50251	1/2" FLAT WASHER	16
42	BFH-50155	1/2" NYLOCK	8

ALL FLAT WASHERS AND NYLOCKS  
ARE 1/2" UNLESS OTHERWISE NOTED.

**STEP 5:**

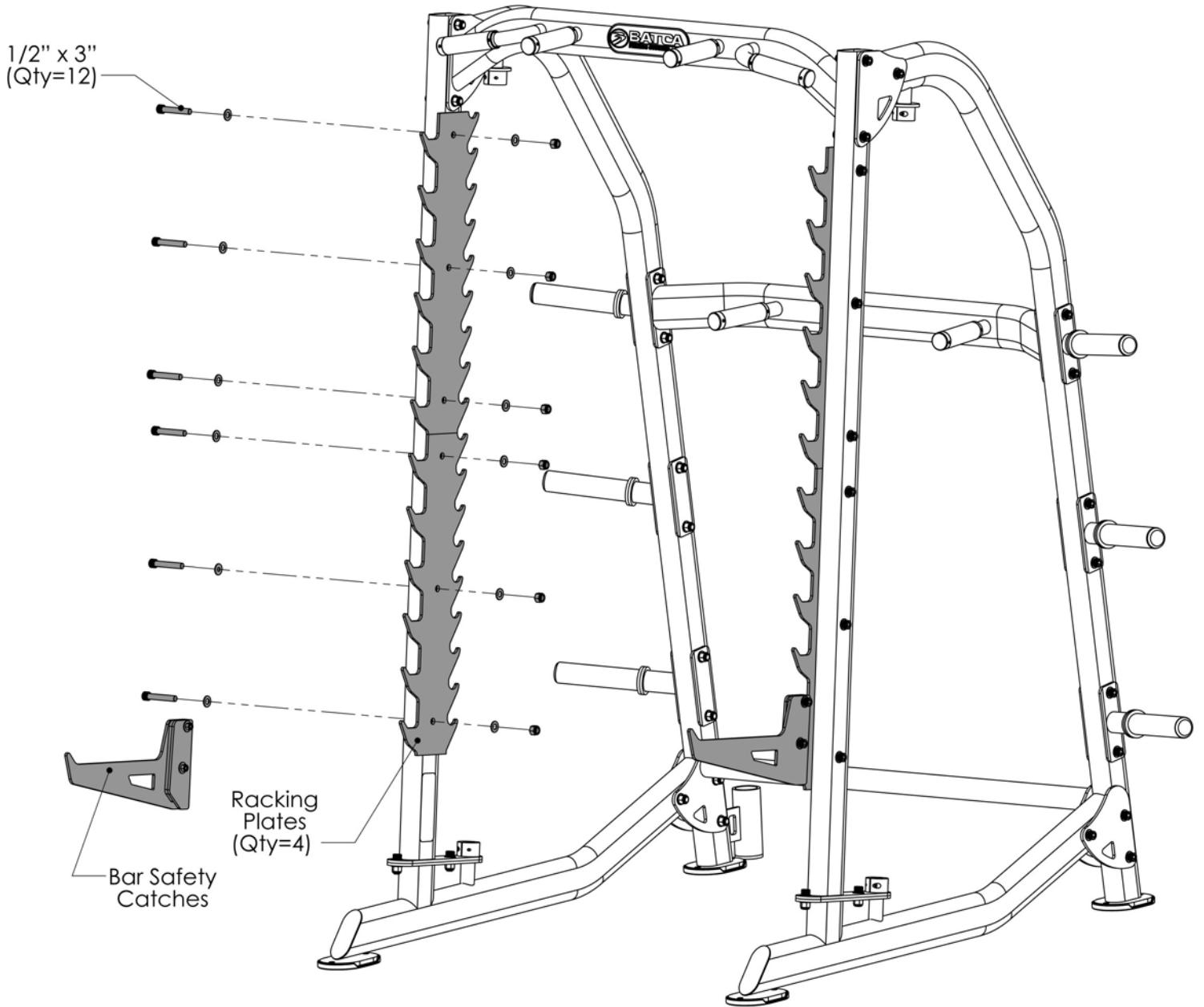

ALL FLAT WASHERS AND NYLOCKS ARE 1/2" UNLESS OTHERWISE NOTED.

ITEM #	PART #	DESCRIPTION	QTY
18	BFP-52307	RACKING PLATES	4
19	BFP-11021	FREWEIGHT SAFETY CATCHES	2
37	BFP-52337	SHCS 1/2" x 3"	12
40	BFH-50251	1/2" FLAT WASHER	24
42	BFH-50155	1/2" NYLOCK	12

## STEP 6:

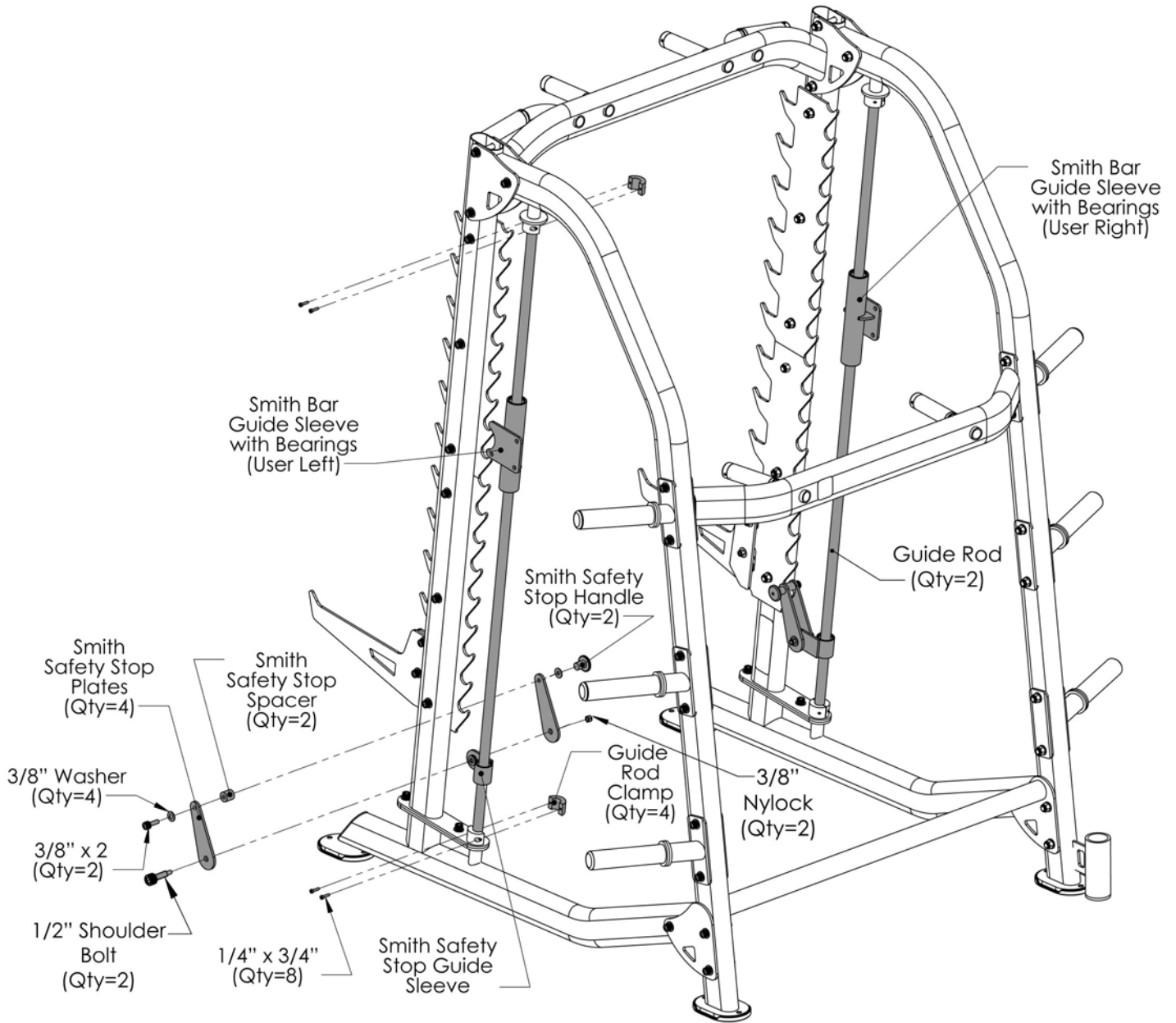

ITEM #	PART #	DESCRIPTION	QTY
20	BFP-11001	SMITH BAR GUIDE SLEEVE WITH BEARINGS (USER LEFT)	1
21	BFP-11003	SMITH BAR GUIDE SLEEVE WITH BEARINGS (USER RIGHT)	1
22	BFL-50268	SMITH SAFETY STOP PLATES	4
23	BFM-50651	SMITH SAFETY STOP SPACER	2
24	BFM-51181	SMITH SAFETY STOP HANDLE	2
25	BFP-10999	SMITH SAFETY STOP GUIDE SLEEVE	2
26	BFP-52295	GUIDE ROD CLAMP	4
27	BFP-52306	GUIDE ROD	2
32	BFP-52393	SHCS 1/4" x 3/4"	8
36	BFP-51759	SHCS 3/8" x 2"	2
39	BFH-50146	3/8" FLAT WASHER	4
41	BFH-50157	3/8 NYLOCK"	2
43	BFP-52392	3/8" SHOULDER BOLT	2

ALL FLAT WASHERS AND NYLOCKS ARE 1/2" UNLESS OTHERWISE NOTED.

**STEP 7:**

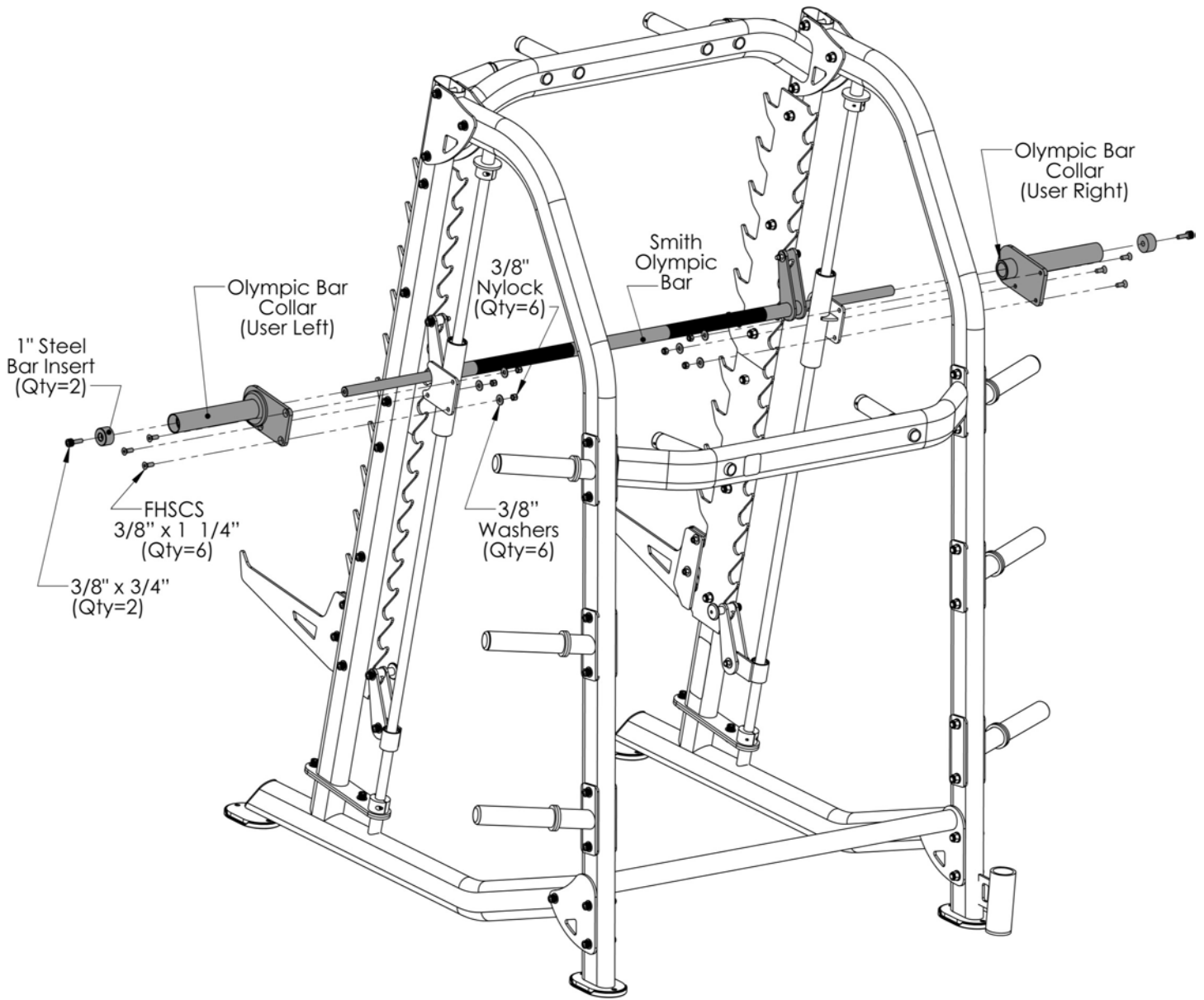

ALL FLAT WASHERS AND NYLOCKS ARE 1/2\"/>

ITEM #	PART #	DESCRIPTION	QTY
28	BFM-10697	SMITH OLYMPIC BAR	1
29	BFP-11002	OLYMPIC BAR COLLAR (USER LEFT)	1
30	BFP-11004	OLYMPIC BAR COLLAR (USER RIGHT)	1
31	BFP-52391	1\"/>	
33	BFP-52340	SHCS 3/8\"/>	
35	BFP-52390	FHSCS 3/8\"/>	
39	BFH-50146	3/8\"/>	
41	BFH-50157	3/8\"/>	

# PREVENTIVE MAINTENANCE

BATCA FITNESS SYSTEMS STRIVES TO GIVE YOU THE VERY BEST IN QUALITY, PERFORMANCE AND SAFETY THROUGH CAREFULLY ENGINEERED DESIGNS AND EXCELLENT WORKMANSHIP. IN ORDER TO MAINTAIN THIS HIGH LEVEL OF QUALITY THE PREVENTATIVE MAINTENANCE SCHEDULE BELOW SHOULD BE FOLLOWED.

CLEAN UPHOLSTERY, GRIPS, AND ROLLER PADS WITH MILD SOAP AND WATER GENERALLY AFTER EVERY USE. THE GUIDE RODS, CHROME SLIDES AND FRAME SHOULD BE CLEANED WITH A COTTON CLOTH. UPON CLEANING THE GUIDE RODS, A THIN LAYER OF SILICONE OR TEFLON GEL SHOULD BE APPLIED TO EACH ROD TO ENSURE A GLASS SMOOTH PERFORMANCE.

AN OVERALL INSPECTION SHOULD BE DONE BEFORE EACH WORKOUT. IF THE WARNING AND SAFETY DECALS ARE WORN OR HAVE BEEN REMOVED THEY SHOULD BE REPLACED IMMEDIATELY. THE CABLES AND CABLE SYSTEMS SHOULD BE INSPECTED FOR SIGNS OF WEAR AND PROPER TENSION. IN ORDER TO CHECK CABLES PROPERLY YOU SHOULD CAREFULLY RUN THE CABLE THROUGH YOUR FINGERTIPS, CHECKING FOR SIGNS OF WEAR, CRACKS, BURS AND THINNING SPOTS. REPLACE ANY PART AT FIRST SIGNS OF WEAR. CABLES SHOULD BE ADJUSTED FOR PROPER TENSION. SEE ASSEMBLY INSTRUCTIONS FOR THIS DETAIL. ALL HARDWARE, STOPS, AND ADJUSTMENTS SHOULD BE CHECKED AND TIGHTENED AS REQUIRED.

THE GUIDE RODS ON YOUR MACHINE SHOULD BE CLEANED AND LUBRICATED REGULARLY. THIS WILL ENSURE A GLASS SMOOTH PERFORMANCE FROM YOUR WEIGHT STACK. A THIN LAYER OF EITHER SILICONE OR TEFLON GEL SHOULD APPLIED TO EACH ROD. EACH PILLOW BLOCK BEARING AND FLANGE BEARING HAS A GREASE FITTINGS THAT MUST BE LUBRICATED REGULARLY. USE GENERAL PURPOSE BEARING GREASE AND FOLLOW THE SCHEDULE BELOW.

ALTHOUGH CABLES SHOULD BE INSPECTED DAILY, IT IS IMPORTANT THAT ALL CABLES BE REPLACED AS DIRECTED IN THE SCHEDULE BELOW. PLEASE NOTE THAT AT ANY FIRST SIGN OF WEAR THE CABLE SHOULD BE REPLACED IMMEDIATELY.

IF THERE ARE ANY QUESTIONS CONCERNING MAINTENANCE, PLEASE CONTACT YOUR LOCAL BATCA DEALER OR CONTACT BATCA FITNESS SYSTEMS DIRECTLY AT:

BATCA FITNESS SYSTEMS  
(919) 255-1233  
WWW.BATCAFITNESS.COM

	DAILY		WEEKLY		MONTHLY		QUARTERLY		YEARS	
	Commercial	Home	Commercial	Home	Commercial	Home	Commercial	Home	Commercial	Home
<b>CLEAN</b>										
UPHOLSTERY										
HAND GRIPS	X			X						
ROLLER PADS										
GUIDE RODS			X			X				
CHROME SLIDES			X			X				
FRAME			X			X				
<b>INSPECT</b>										
OVERALL	X	X								
SAFETY DECALS	X	X								
CABLES										
CABLE TENSION										
PULLEYS										
HARDWARE	X	X								
STOPS	X	X								
UPHOLSTERY										
HAND GRIPS			X			X				
FRAME			X			X				
BUSHINGS	X			X						
BEARINGS	X			X						
<b>LUBRICATE</b>										
GUIDE RODS			X			X				
BEARINGS							As Needed			1
<b>REPLACE</b>										
CABLES										

# LIMITED LIFETIME WARRANTY

## ***WHAT IS COVERED***

### FOR RESIDENTIAL USE:

BATCA FITNESS SYSTEMS WARRANTS ALL OF ITS PRODUCTS AGAINST DEFECTS IN MANUFACTURING, MATERIALS AND WORKMANSHIP UNDER NORMAL USE AND SERVICE FOR ONE YEAR FROM DATE OF PURCHASE INCLUDING PAINT, CHROME, UPHOLSTERY AND GRIPS. BATCA FITNESS SYSTEMS ALSO WARRANTS ALL CABLES, BELTS, BOLTS, NUTS, CAPS, PLUGS, BUMPERS, WASHERS, LEVELERS, DECALS, GAS SPRINGS AND OTHER HARDWARE FOR THREE YEARS AFTER DATE OF PURCHASE; ALL MOVING PARTS, INCLUDING PULLEYS, BUSHINGS, BEARINGS AND PULL PINS FOR FIVE YEARS AFTER DATE OF PURCHASE AND WARRANTS THE FRAME AND ALL WELDED PARTS FOR THE LIFETIME OF THE ORIGINAL PURCHASER.

### FOR COMMERCIAL USE:

BATCA FITNESS SYSTEMS WARRANTS ALL OF ITS PRODUCTS AGAINST DEFECTS IN MANUFACTURING, MATERIALS AND WORKMANSHIP UNDER NORMAL USE AND SERVICE FOR SIX MONTHS FROM DATE OF PURCHASE INCLUDING PAINT, CHROME, UPHOLSTERY AND GRIPS. BATCA FITNESS SYSTEMS ALSO WARRANTS ALL CABLES, BELTS, BOLTS, NUTS, CAPS, PLUGS, BUMPERS, WASHERS, LEVELERS, DECALS, GAS SPRINGS AND OTHER HARDWARE FOR ONE YEAR AFTER DATE OF PURCHASE; ALL MOVING PARTS, INCLUDING PULLEYS, BUSHINGS, BEARINGS AND PULL PINS FOR THREE YEARS AFTER DATE OF PURCHASE AND WARRANTS THE FRAME AND ALL WELDED PARTS FOR TEN YEARS AFTER DATE OF PURCHASE.

## ***WHAT IS NOT COVERED***

THIS WARRANTY DOES NOT COVER DAMAGE, WHICH RESULTS FROM SHIPPING, MISUSE, ABUSE, NEGLIGENCE, CARELESSNESS, MODIFICATION OR ALTERATION, ACCIDENT, FIRE, FLOOD, "ACTS OF GOD" OR OTHER CONTINGENCIES BEYOND THE CONTROL OF BATCA FITNESS SYSTEMS. THIS WARRANTY ALSO DOES NOT COVER DETERIORATION FROM WEAR AND TEAR OR EXPOSURE OR ANY DEFECT, WHICH WOULD NOT HAVE HAPPENED IF INSTRUCTIONS IN THE OWNER'S MANUAL HAD BEEN FOLLOWED. IMPROPER INSTALLATION, IMPROPER ASSEMBLY OR FOLLOW-UP MAINTENANCE ALONG WITH INSTALLATION OF PARTS OR ACCESSORIES NOT ORIGINALLY INTENDED FOR PRODUCTS OF BATCA FITNESS SYSTEMS ARE ALSO NOT COVERED BY THIS WARRANTY. ONLY GENUINE BATCA PARTS SHOULD BE USED FOR REPLACEMENT, REPAIR, AND MAINTENANCE FOR THIS WARRANTY TO APPLY.

DEFECTIVE PARTS WILL BE REPAIRED OR REPLACED AT BATCA FITNESS SYSTEMS OPTION, WITHOUT PARTS CHARGE TO THE PURCHASER. ALL RETURNS REQUIRE A RETURN AUTHORIZATION PRIOR TO ACCEPTANCE OF REPAIR WORK. BATCA FITNESS SYSTEMS RESERVES THE RIGHT TO MAKE DESIGN CHANGES WITHOUT ANY PRIOR NOTIFICATION AND SHALL NOT BE RESPONSIBLE FOR INCIDENTAL OR CONSEQUENTIAL DAMAGES.

THE PURCHASER IS RESPONSIBLE FOR SHIPPING THE DEFECTIVE PART BACK TO THE FACTORY. REPAIR OR REPLACEMENT IS THE EXCLUSIVE AND SOLE REMEDY OF THE PURCHASER. LABOR CHARGES ASSOCIATED WITH PARTS CHANGES ARE NOT COVERED BY THIS WARRANTY. PROOF OF PURCHASE, SERIAL NUMBER, MODEL NUMBER AND DATE OF PURCHASE WILL BE REQUIRED ALONG WITH ALL PERTINENT INFORMATION OF THE ALLEGED DAMAGE.

THIS WARRANTY APPLIES ONLY TO THE ORIGINAL PURCHASER AND IS NOT TRANSFERABLE. CLAIMS UNDER THIS WARRANTY MUST BE MADE DIRECTLY TO BATCA FITNESS SYSTEMS.

BATCA FITNESS SYSTEMS  
1207 N. NEW HOPE ROAD  
RALEIGH, NC 27610  
(919) 255-1233

[WWW.BATCAFITNESS.COM](http://WWW.BATCAFITNESS.COM)



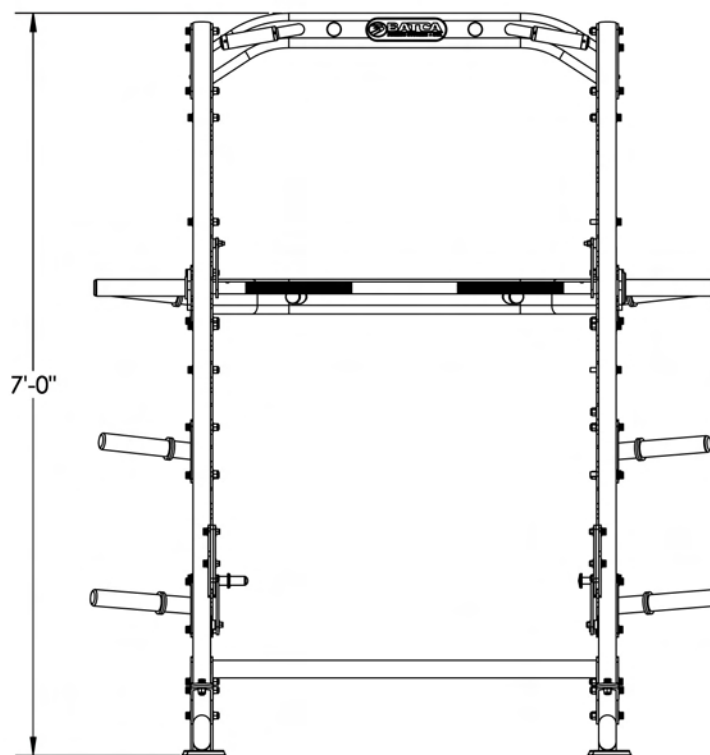
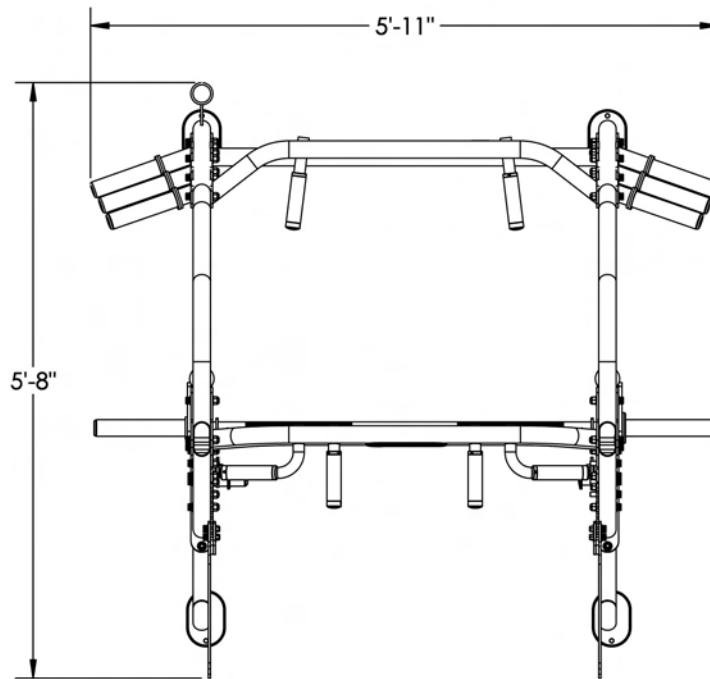

## LAYOUT DIAGRAM

THE LINK SMITH MACHINE HAS A LAYOUT DIMENSION OF 5'-11" (WIDTH) X 5'-8" (LENGTH) X 7'-0" (HEIGHT). THERE SHOULD BE A MINIMUM OF 18", PREFERABLY 24", OF WORKING SPACE AROUND THE ENTIRE UNIT.